

### Physical Specification (mm)

Nominal Voltage		12V
Nominal Capacity(20HR)		32Ah
Dimension	Length	195 ± 2mm(7.68inches)
	Width	126 ± 2mm(4.96inches)
	Container Height	201 ± 2mm(7.91inches)
	Total Height(with Terminal)	221 ± 2mm(8.70inches)
Weight With Acid		Approx 9.4Kg(20.7lbs)
Acid		1.280 ± 0.015g/cm <sup>3</sup> (25°C)
Standard Terminal		3
Cell layout		1
Hold-Down		B0
Case		Black-Material (PP)
Cover		Black-Material (PP)
Handle		Black-Material (PP)

### Electrical Specification

Rated Capacity	20 hour rate(1.6A)	32Ah
Reserve Capacity (RC)25A@10.5V		47min
Cold Cranking Performance Amps(CCA) @0°F(-18°C)		310A(JIS)

### Standard Terminal (mm)

Terminal Type	D	
	Positive	Negative
3	14.7 <sup>0</sup> <sub>-0.3</sub>	13.0 <sup>0</sup> <sub>-0.3</sub>



### Dimensions (mm)

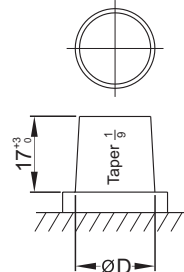
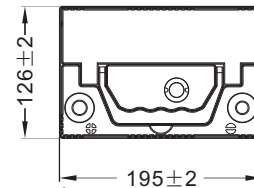
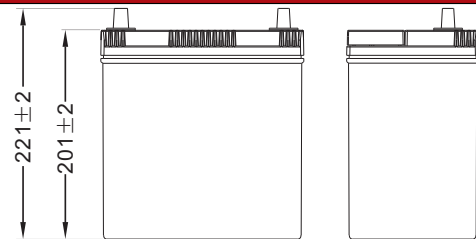

### Cell Layout

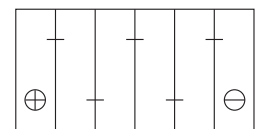

Figure(1)

### Discharge Characteristics

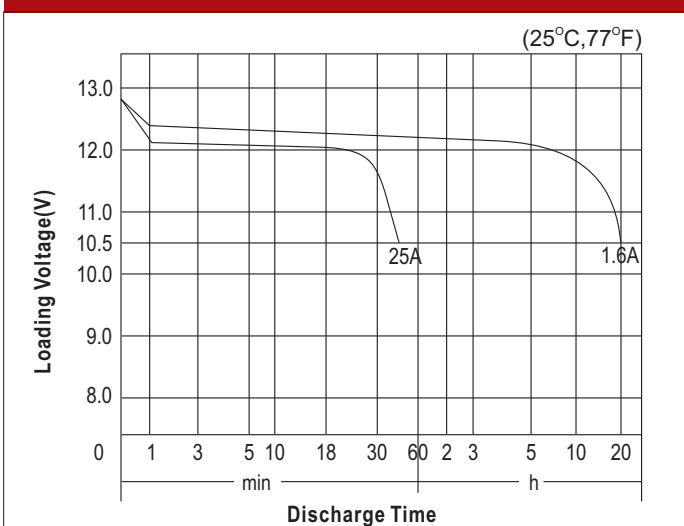

### Discharge Characteristics

