

Physical Specification (mm)

Nominal Voltage		12V
Nominal Capacity(20HR)		135Ah
Dimension	Length	504 ± 2mm(19.84inches)
	Width	180 ± 2mm(7.09inches)
	Container Height	208 ± 2mm(8.19inches)
	Total Height(with Terminal)	232 ± 2mm(9.13inches)
Weight With Acid		Approx 34.9Kg(76.9lbs)
Acid		1.280 ± 0.015g/cm ³ (25°C)
Standard Terminal		1
Cell layout		3
Hold-Down		B0
Case		Black-Material (PP)
Cover		Black-Material (PP)
Handle		Black-Material (Nylon)

Electrical Specification

Rated Capacity	20 hour rate(6.75A)	135Ah
Reserve Capacity (RC)25A@10.5V		256min
Cold Cranking Performance Amps(CCA) @0°F(-18°C)		850A(JIS)

Standard Terminal (mm)

Terminal Type	D	
	Positive	Negative
1	19.5 ⁰ _{-0.3}	17.9 ⁰ _{-0.3}



Dimensions (mm)

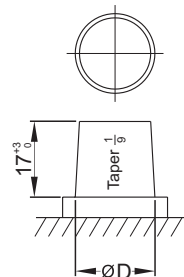
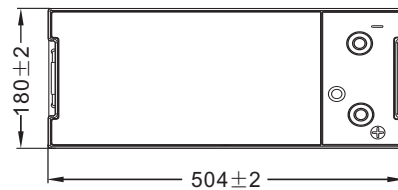
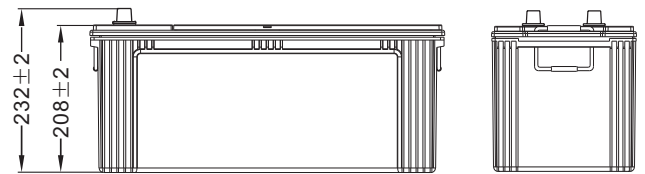

Cell Layout

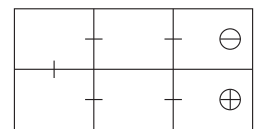

Figure(3)

Discharge Characteristics

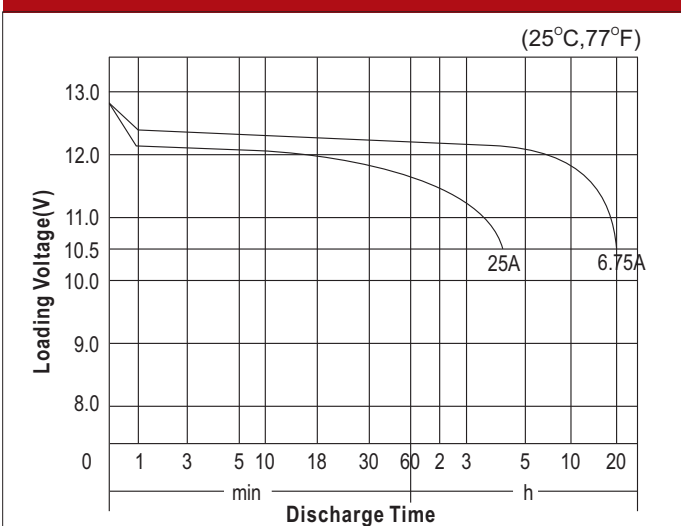

Discharge Characteristics

