

### Physical Specification (mm)

Nominal Voltage		12V
Nominal Capacity(20HR)		83Ah
Dimension	Length	304 ± 2mm(11.97inches)
	Width	171 ± 2mm(6.73inches)
	Container Height	203 ± 2mm(7.99inches)
	Total Height(with Terminal)	224 ± 2mm(8.82inches)
Weight With Acid		Approx 21.1Kg(46.5lbs)
Acid		1.280 ± 0.015g/cm <sup>3</sup> (25°C)
Standard Terminal		1
Cell layout		1
Hold-Down		B1
Case		Black-Material (PP)
Cover		Black-Material (PP)
Handle		Black-Material (PP)

### Electrical Specification

Rated Capacity	20 hour rate(4.15A)	83Ah
Reserve Capacity (25A@10.5V)		145min
Cold Cranking Performance Amps(CCA) @0°F(-18°C)		610A(EN)

### Standard Terminal (mm)

Terminal Type	D	
	Positive	Negative
1	19.5 <sup>0</sup> <sub>-0.3</sub>	17.9 <sup>0</sup> <sub>-0.3</sub>



### Dimensions (mm)

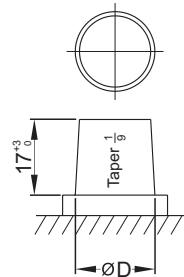
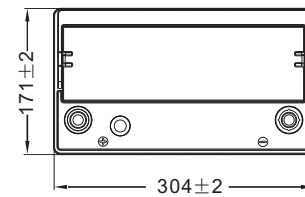
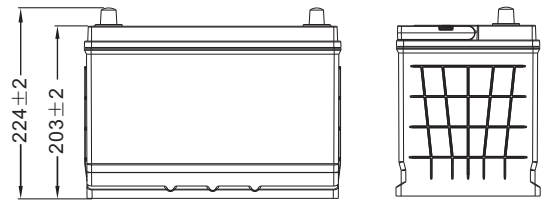

### Cell Layout

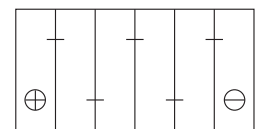

Figure(1)

### Discharge Characteristics

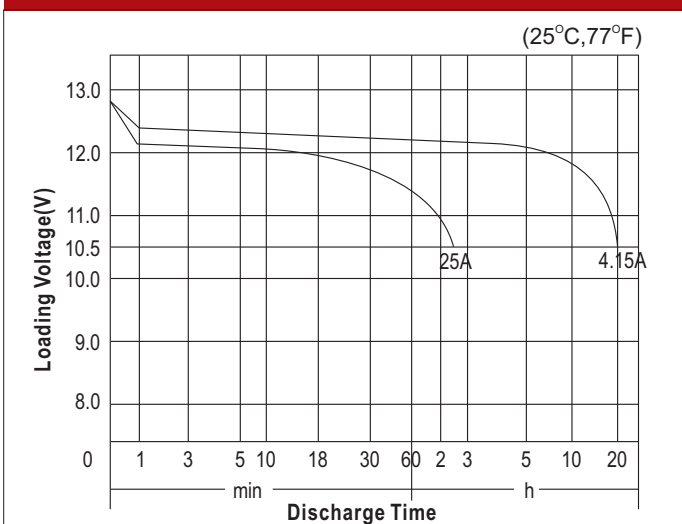

### Discharge Characteristics

