

### Physical Specification (mm)

Nominal Voltage		12V
Nominal Capacity(20HR)		83Ah
Dimension	Length	303±2mm(11.93inches)
	Width	170±2mm(6.69inches)
	Container Height	201±2mm(7.91inches)
	Total Height(with Terminal)	222±2mm(8.74inches)
Weight With Acid		Approx 21.1Kg(46.5lbs)
Acid		1.280±0.015g/cm <sup>3</sup> (25°C)
Standard Terminal		1
Cell layout		0
Hold-Down		B1
Case		Black-Material (PP)
Cover		Black-Material (PP)
Handle		Black-Material (PP)

### Dimensions (mm)

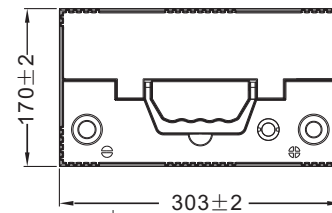
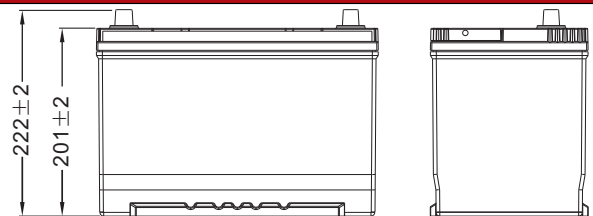

### Cell Layout

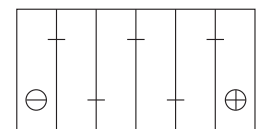
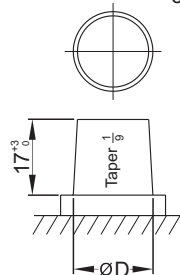

Figure(0)

### Electrical Specification

Rated Capacity	20 hour rate(4.15A)	83Ah
Reserve Capacity (RC)25A@10.5V		145min
Cold Cranking Performance Amps(CCA) @0°F(-18°C)		610A(EN)

### Standard Terminal (mm)

Terminal Type	D	
	Positive	Negative
1	19.5 <sup>0</sup> <sub>-0.3</sub>	17.9 <sup>0</sup> <sub>-0.3</sub>

### Discharge Characteristics

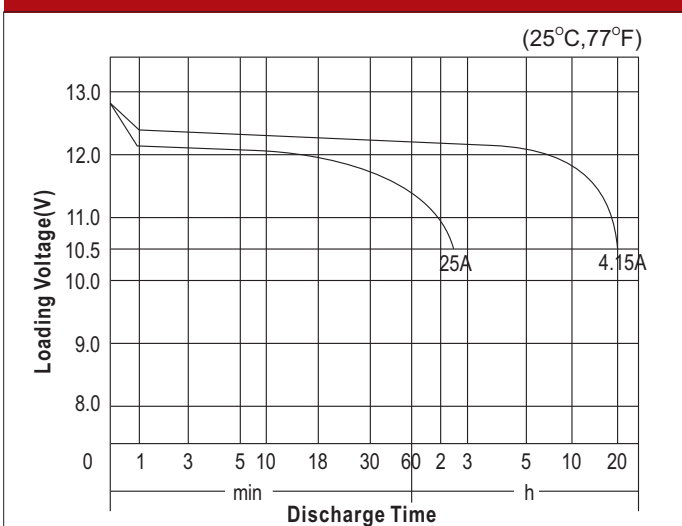

### Discharge Characteristics

