

### Physical Specification (mm)

Nominal Voltage		12V
Nominal Capacity(20HR)		72Ah
Dimension	Length	274±2mm(10.79inches)
	Width	174±2mm(6.85inches)
	Container Height	190±2mm(7.48inches)
	Total Height(with Terminal)	190±2mm(7.48inches)
Weight With Acid		Approx 17.5Kg(38.6lbs)
Acid		1.280±0.015g/cm <sup>3</sup> (25°C)
Standard Terminal		1
Cell layout		0
Hold-Down		B13
Case		Black-Material (PP)
Cover		Black-Material (PP)
Handle		Black-Material (PP)

### Electrical Specification

Rated Capacity	20 hour rate(3.6A)	72Ah
Reserve Capacity (25A@10.5V)		122min
Cold Cranking Performance Amps(CCA) @0°F(-18°C)		600A(EN)

### Standard Terminal (mm)

Terminal Type	D	
	Positive	Negative
1	19.5 <sup>0</sup> <sub>-0.3</sub>	17.9 <sup>0</sup> <sub>-0.3</sub>



Dimensions (mm)

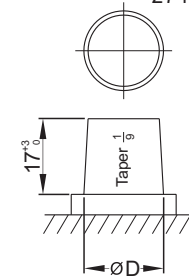
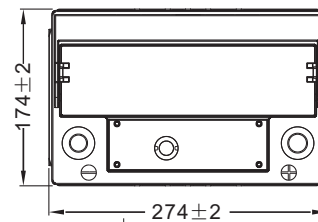
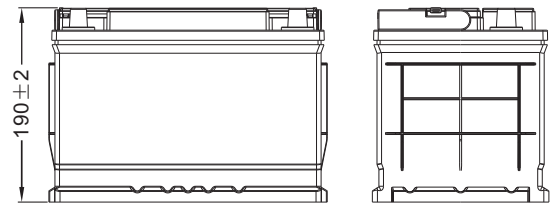

Cell Layout

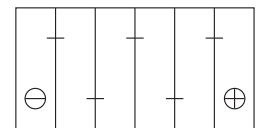

Figure(0)

### Discharge Characteristics

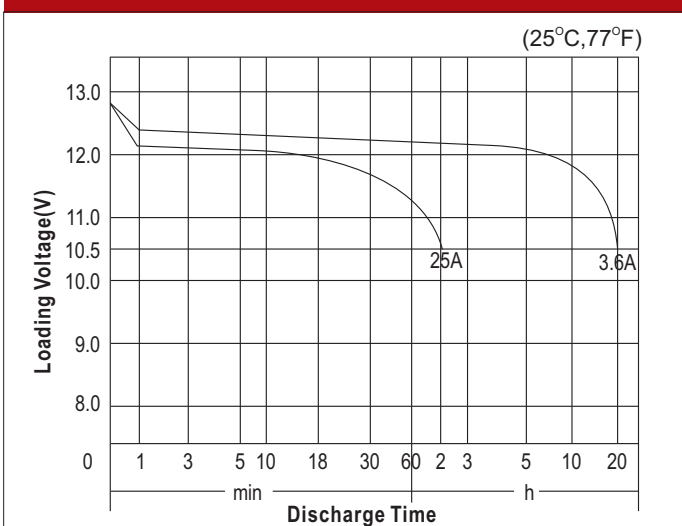

### Discharge Characteristics

