

Physical Specification (mm)

Nominal Voltage		12V
Nominal Capacity(20HR)		68Ah
Dimension	Length	276±2mm(10.87inches)
	Width	174±2mm(6.85inches)
	Container Height	174±2mm(6.85inches)
	Total Height(with Terminal)	174±2mm(6.85inches)
Weight With Acid		Approx 16.7Kg(36.8lbs)
Acid		1.280±0.015g/cm ³ (25°C)
Standard Terminal		1
Cell layout		0
Hold-Down		B13
Case		Black-Material (PP)
Cover		Black-Material (PP)
Handle		Black-Material (PP)

Electrical Specification

Rated Capacity	20 hour rate(3.4A)	68Ah
Reserve Capacity (25A@10.5V)		115min
Cold Cranking Performance Amps(CCA) @0°F(-18°C)		580A(EN)

Standard Terminal (mm)

Terminal Type	D	
	Positive	Negative
1	19.5 ⁰ _{-0.3}	17.9 ⁰ _{-0.3}

Discharge Characteristics

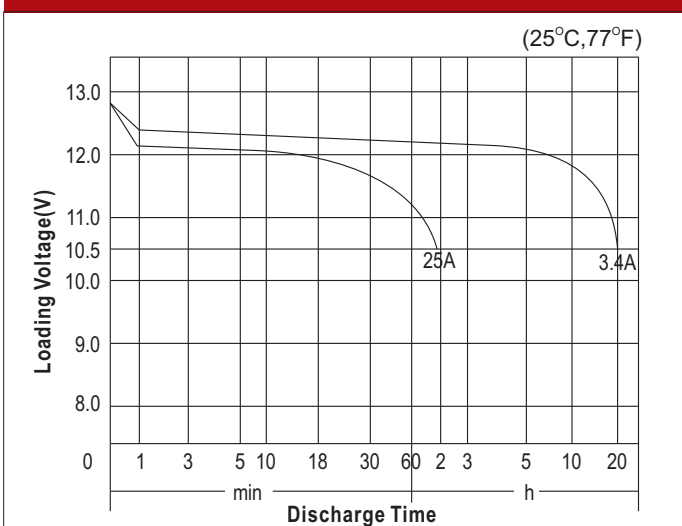

Discharge Characteristics

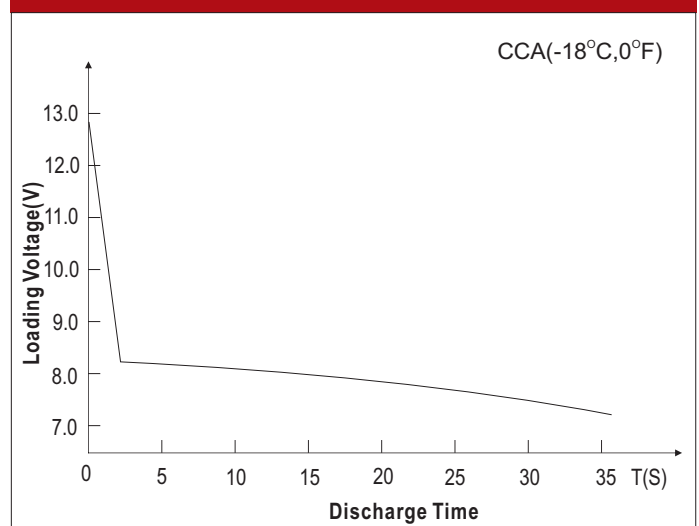

Dimensions (mm)

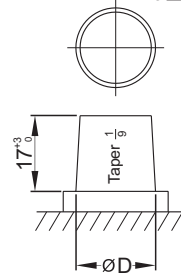
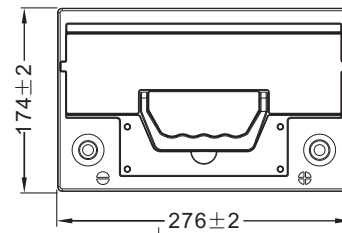
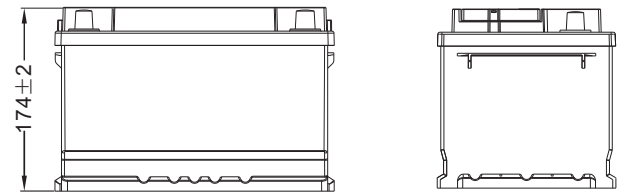

Cell Layout

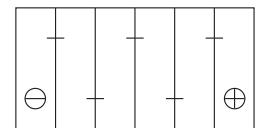

Figure(0)