

### Physical Specification (mm)

Nominal Voltage		12V
Nominal Capacity(20HR)		60Ah
Dimension	Length	230 ± 2mm(9.06inches)
	Width	170 ± 2mm(6.69inches)
	Container Height	202 ± 2mm(7.95inches)
	Total Height(with Terminal)	222 ± 2mm(8.74inches)
Weight With Acid		Approx 15.5Kg(34.2lbs)
Acid		1.280 ± 0.015g/cm <sup>3</sup> (25°C)
Standard Terminal		1
Cell layout		1
Hold-Down		B0
Case		Black-Material (PP)
Cover		Black-Material (PP)
Handle		Black-Material (PP)

### Dimensions (mm)

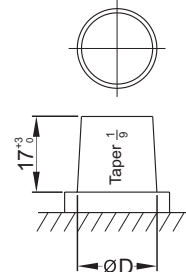
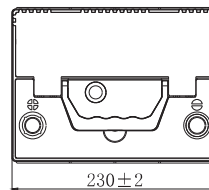
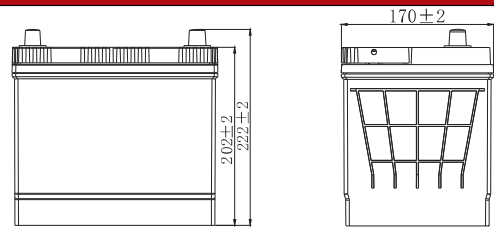

### Cell Layout

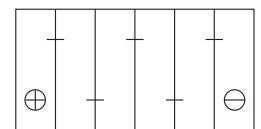

Figure(1)

### Electrical Specification

Rated Capacity	20 hour rate(3.0A)	60Ah
Reserve Capacity (25A@10.5V)		98min
Cold Cranking Performance Amps(CCA) @0°F(-18°C)		450A(EN)

### Standard Terminal (mm)

Terminal Type	D	
	Positive	Negative
1	19.5 <sup>0</sup> <sub>-0.3</sub>	17.9 <sup>0</sup> <sub>-0.3</sub>

### Discharge Characteristics

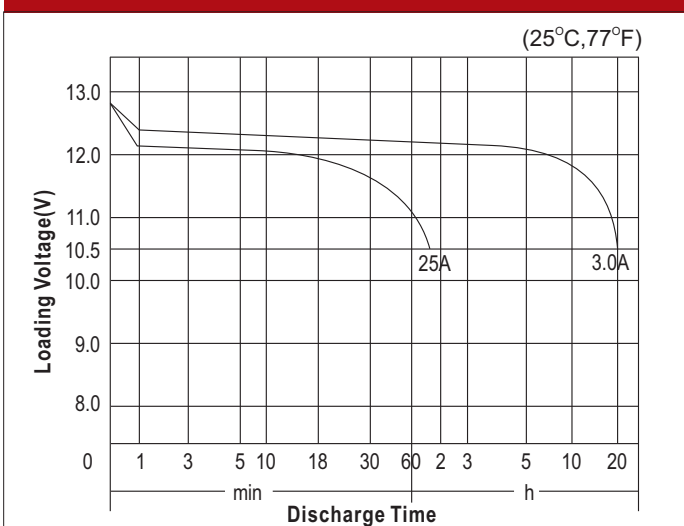

### Discharge Characteristics

